

SHIFT BOOT RETAINER PLUS+ FITMENT GUIDE

OVERVIEW

The Shift Boot Retainer PLUS+ is available in one size and features a 19mm internal bore.

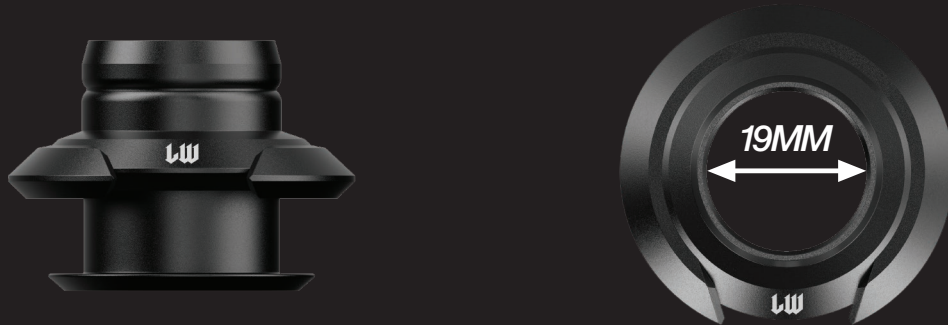

O-RINGS

The Shift Boot Retainer PLUS+ connects directly to our PLUS+ shifters using a precisely engineered o-ring system.



To check fitment compatibility, your shifter assembly must fit within the green area shown below.

This area is measured 35mm from below the threads and must be no wider than 19mm in diameter.

The shifter assembly can be any shape, as long as it fits within these parameters.

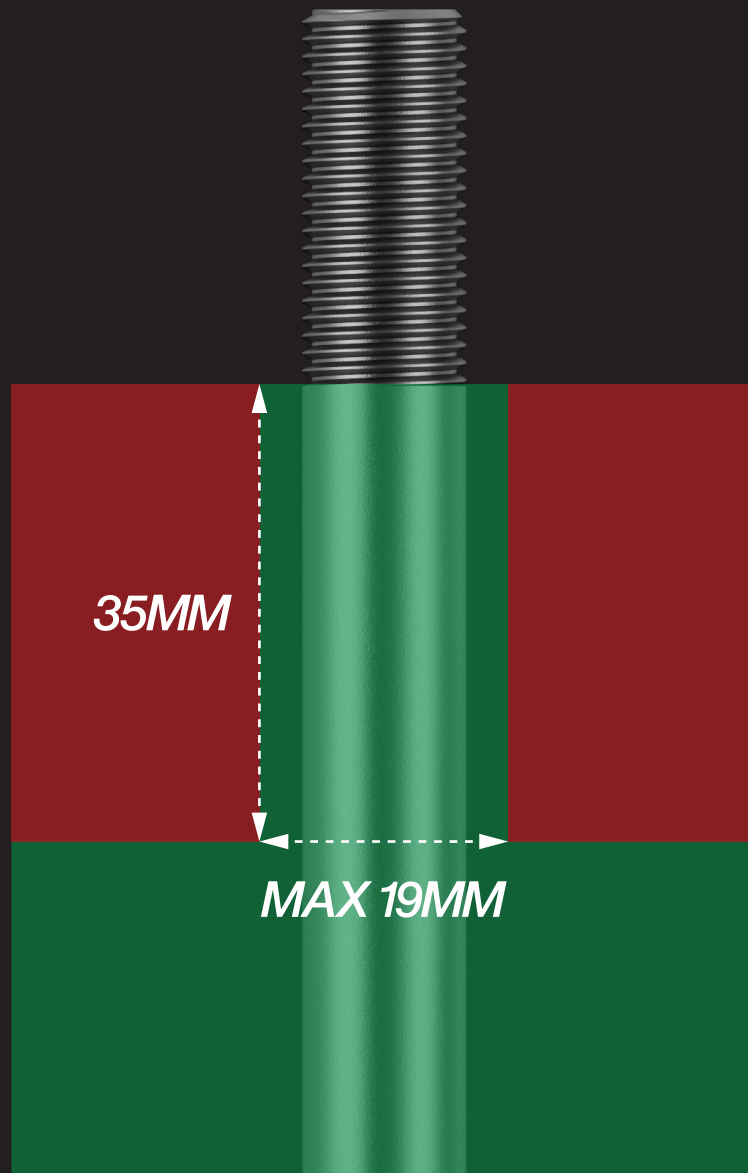

COMPATIBLE AREA



NOT COMPATIBLE AREA

The following shifter assemblies are compatible:

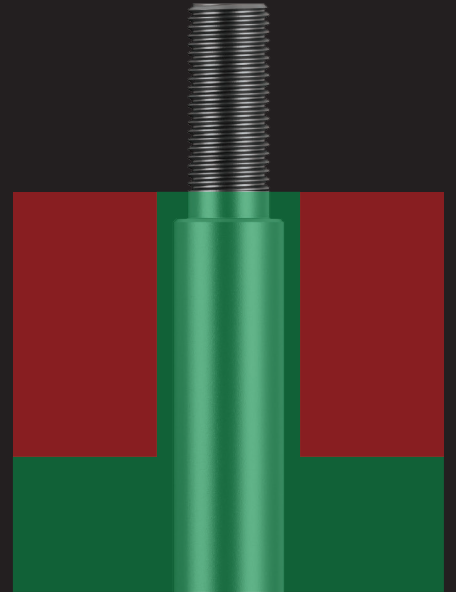
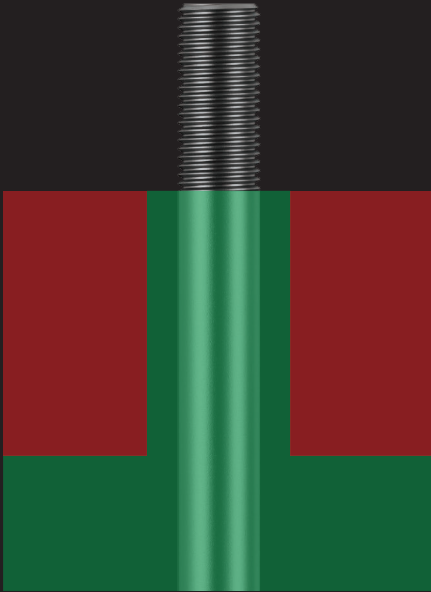

The following shifter assemblies are not compatible:

